

TENNESSEE

RIVER MILE 467 +

RIVER

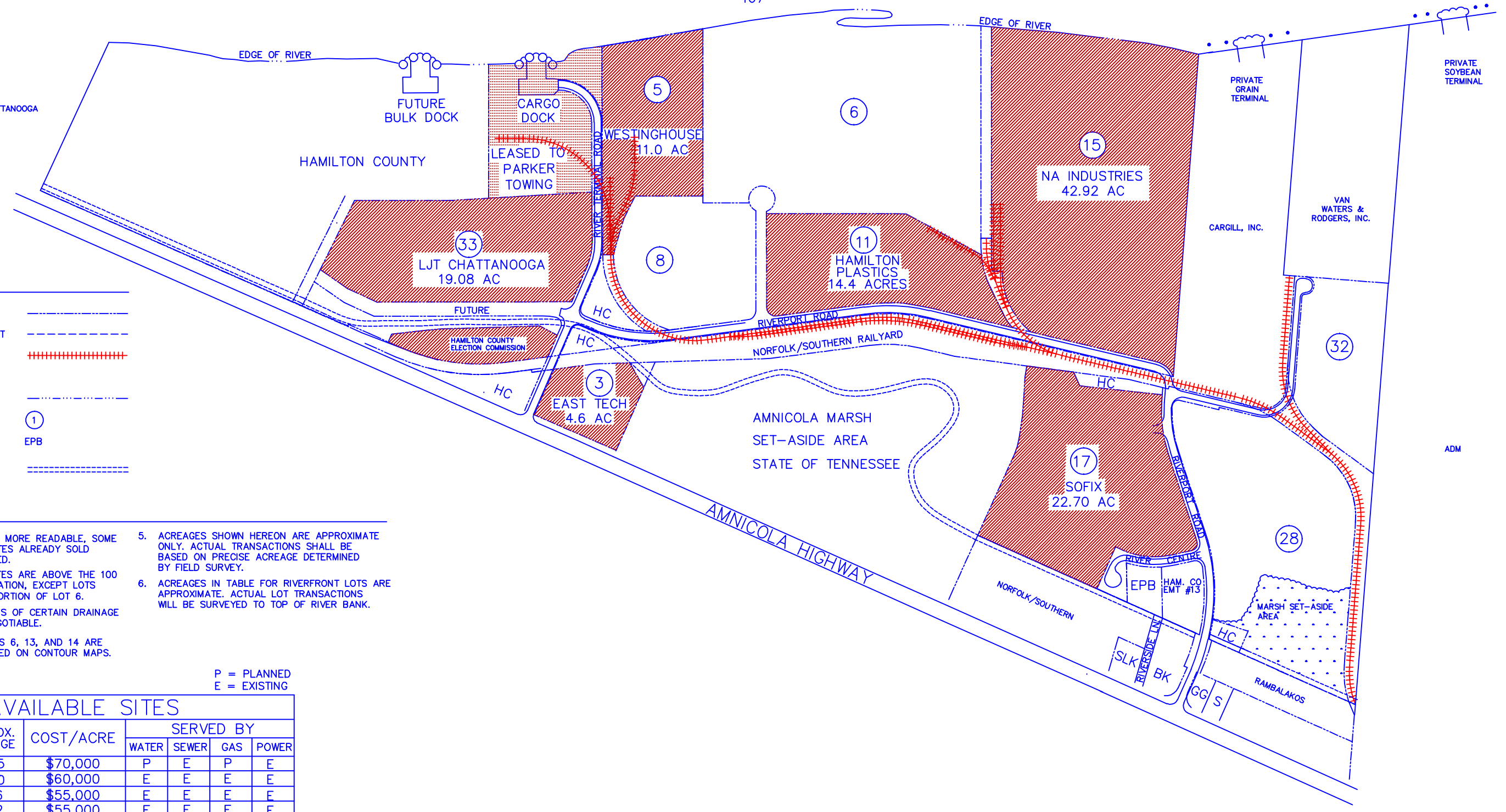

LEGEND

- PROPERTY LINE
- DRAINAGE/UTILITY ESMT
- EXISTING RAIL
- PROPOSED RAIL
- EXIST. TOP OF BERM
- TRACT NUMBER
- ELECTRIC POWER BOARD SUBSTATION
- RIVERWALK

NOTES:

1. TO MAKE DRAWING MORE READABLE, SOME DETAILS WITHIN SITES ALREADY SOLD HAVE BEEN OMITTED.
2. ALL AVAILABLE SITES ARE ABOVE THE 100 YEAR FLOOD ELEVATION, EXCEPT LOTS 13, 14, AND A PORTION OF LOT 6.
3. PERMANENT STATUS OF CERTAIN DRAINAGE EASEMENTS IS NEGOTIABLE.
4. ACREAGE FOR LOTS 6, 13, AND 14 ARE APPROXIMATE BASED ON CONTOUR MAPS.
5. ACREAGES SHOWN HEREON ARE APPROXIMATE ONLY. ACTUAL TRANSACTIONS SHALL BE BASED ON PRECISE ACREAGE DETERMINED BY FIELD SURVEY.
6. ACREAGES IN TABLE FOR RIVERFRONT LOTS ARE APPROXIMATE. ACTUAL LOT TRANSACTIONS WILL BE SURVEYED TO TOP OF RIVER BANK.

P = PLANNED
E = EXISTING

AVAILABLE SITES						
TRACT	APPROX. ACREAGE	COST/ACRE	SERVED BY			
			WATER	SEWER	GAS	POWER
6	31.5	\$70,000	P	E	P	E
8	12.0	\$60,000	E	E	E	E
28	19.6	\$55,000	E	E	E	E
32	10.2	\$55,000	E	E	E	E

CENTRE SOUTH
Riverport/Industrial Park
Chattanooga, Tennessee

April 14, 2008

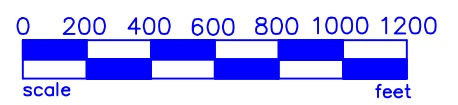

Hamilton County Public Works
Real Property Office

Chattanooga, Tennessee
Ph. (423) 209-6444